

MOTORIZED MOBILE FLAT SCREEN TV CART, 28 CM OF VERTICAL TRAVEL

COLUMN BLACK ANODIZED, H-STYLE BASE

PRODUCT

Motorized flat screen tv cart & mobile monitor stand for 42"-100" (interactive) Flat-Panel displays.

Renowned for its stability and versatility the SCETA28B mobile monitor stand has been Conen Mounts worldwide best-selling mobile stand for many years. The monitor stand is designed to withstand intensive daily use and to safely support displays up to 100" or 136 kg. The SCETA28B tv cart features the standard center column, offering 28 cm of smooth motorized height adjustment.

For user convenience and to enhance the teaching experience the stand allows for several accessories to be mounted, including PC shelves, handles and whiteboard side wings.

Product ships flat-packed. Cartons are courier shippable.

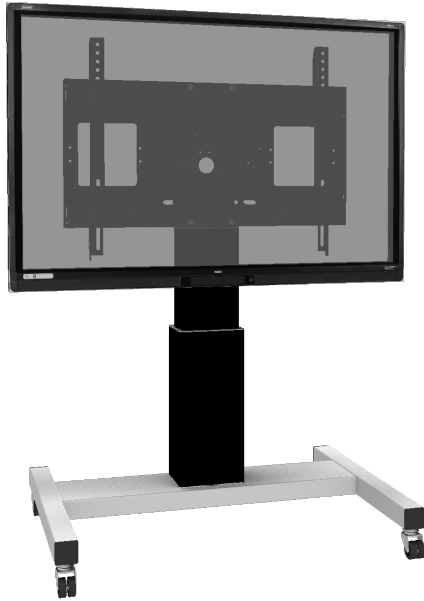

Accessories



Two large and sturdy handles



Keyboard shelf



Extender for height adjustable aluminum columns in different versions



Brackets and wing lock for locking the side wings in front of the display



Front shelf



Front shelf

FEATURES

- Heavy duty mobile tv cart for displays up to 100"
- Easy mounting of display thanks to "pull & release" brackets
- Display mount with integrated cable management
- Wide range of accessories available
- Actuator safely concealed in center column offering 28 cm of vertical travel
- Wired remote is standard included
- Robust H-style base designed to withstand intensive daily use



Display mount



Mobile



Motorized height adjustable



Single display



5 years warranty



Max. load
136 kg / 299.8 lbs



Max. Vesa
800 x 600

Item number	SCETA28B	
Vesa horizontal / Vesa vertical	300 mm - 800 mm / 200 mm - 600 mm	
Frame for all	42" - 100"	
Center to floor distance	885 mm - 1165 mm	34.8" - 45.9"
Load capacity	136 kg	299.8 lbs
Width / Height / Depth	1053 mm / 1205 mm - 1485 mm / 720 mm	41.5" / 47.4" - 58.5" / 28.3"
Weight	55,8 kg	123 lbs
Warranty	5 years limited warranty	
Frame color	RAL 9005 deep black	
Column color	Black anodized	
Base color	RAL 9005 deep black	
Packages	Package dimensions WxHxD	Package weight
AF-SCETA-N	900 x 160 x 450 mm / 35.4 x 6.3 x 17.7"	13,6 kg / 30 lbs
CCE-28WB	680 x 270 x 220 mm / 26.8 x 10.6 x 8.7"	18 kg / 39.7 lbs
MST-SCETAB	1140 x 150 x 780 mm / 44.9 x 5.9 x 30.7"	24,2 kg / 53.4 lbs
Total weight	55,8 kg / 123.1 lbs	

DIMENSIONS

in mm / inch

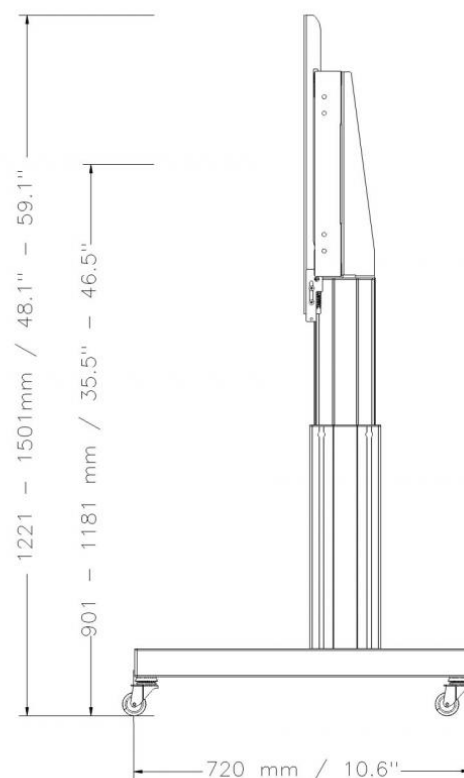
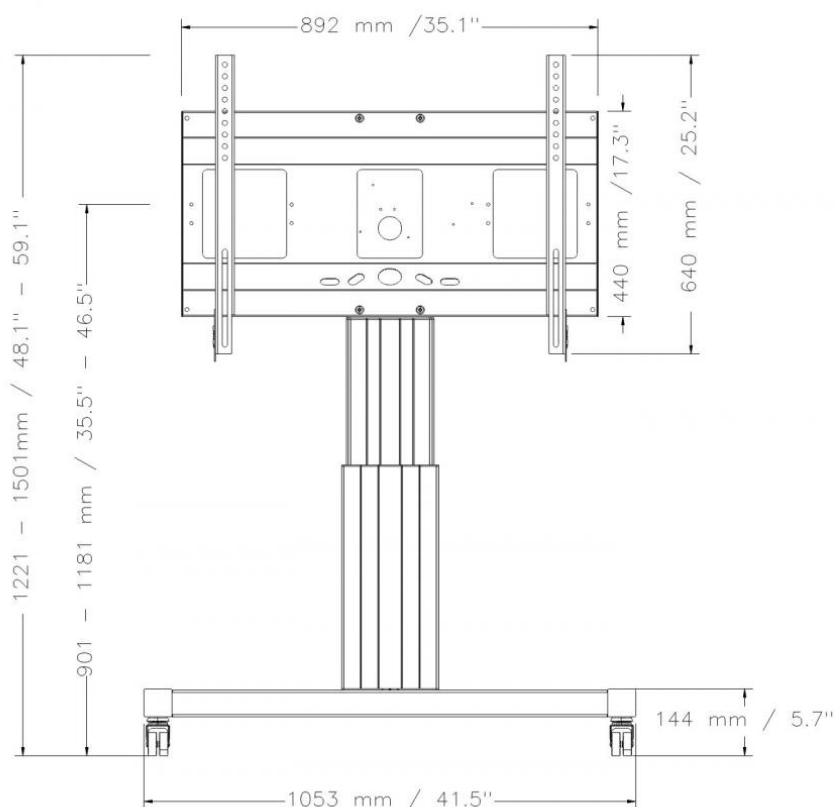

MANUFACTURER:

CONEN Produkte GmbH
Conenstr. 4
54497 Morbach-Gonzerath

Phone: +49 (0) 6533 75-100
Fax: +49 (0) 6533 75-600
E-Mail: info@conenmounts.com

Germany

www.conenmounts.com

CONEN

CONEN is not responsible for printing errors. CONEN reserves the right to change or modify pricing and product specifications with or without prior notification. Illustrations may not be exactly as shown. No parts may be reproduced by any means without prior authorization of CONEN. All rights reserved 2024.