

WALL MOUNTED 2 PYLON SLIDING SYSTEM FOR DISPLAYS FROM 65-86"

MANUALLY HEIGHT-ADJUSTABLE WITH PULLEY AND COUNTER WEIGHT

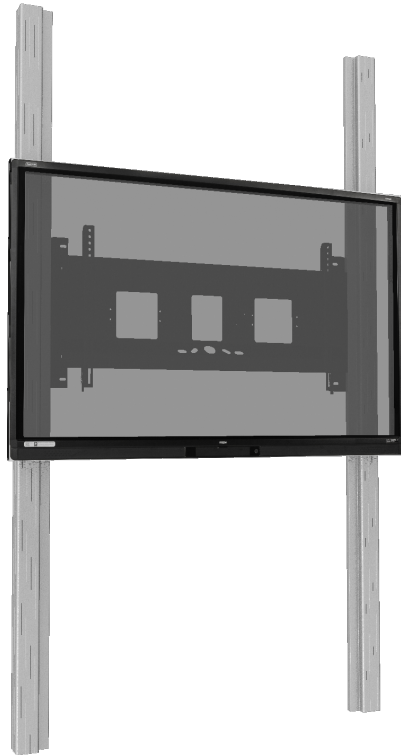

PRODUCT

This manually height-adjustable pylonsystem with pulley is compatible with all touch screen displays available on the market from 65" to 86" screen diagonal.

The two aluminum pylons are mounted on the wall and floor, the display brackets slides between these pylons by pulley and counter weight. This ensures that every user can work and present at the ergonomically best height. A handle is supplied as standard for height adjustment.

Accessories



Keyboard shelf



2 galvanized adjustable wall mounting brackets



2 galvanized wall mounting brackets



Swivel arm for notebooks

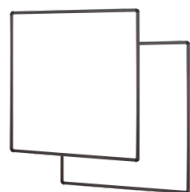

Whiteboard wings for AFSCETAN12

FEATURES

- Please indicate the model of the monitor when placing your order
- Manually height-adjustable system with 2 pylons for floor and wall mounting
- different pylon length available: 2600 mm or 2900 mm
- center to floor distance at 2900 mm length of pylon = approx. 1500 mm - 2100 mm
- center to floor distance at 2600 mm length of pylon = approx. 1150 mm - 1750 mm
- Height adjustment with counterweights and pulley
- All connections on the display are freely accessible
- at least 600 mm stroke



Display mount



Wall mounted



Manual height adjustable



Single display



Max. load
100 kg / 220.5 lbs



Max. Vesa
800 x 600

| | | |
|---------------------------------|--|---------------------|
| Item number | PYF1-IFPD-W | |
| Vesa horizontal / Vesa vertical | 200 mm - 800 mm / 200 mm - 600 mm | |
| Frame for all | 65" - 86" | |
| Center to floor distance | 1500 mm - 2100 mm | 59.1" - 82.7" |
| Load capacity | 100 kg | 220.5 lbs |
| Width / Height / Depth | 1650 mm / 2900 mm / 136 mm | 65" / 114.2" / 5.4" |
| Frame color | RAL 9005 deep black | |
| Column color | Silver anodized | |
| Packages | Package dimensions WxHxD | Package weight |
| AF-PY-NG | | |
| AFPYN12GU | 1300 x 450 x 160 mm / 51.2 x 17.7 x 6.3" | 16,5 kg / 36.4 lbs |
| AI-0019 | | |
| GEWICHT-L | | |
| GEWICHT-R | | |
| PYTVF29 | | |

DIMENSIONS

in mm / inch

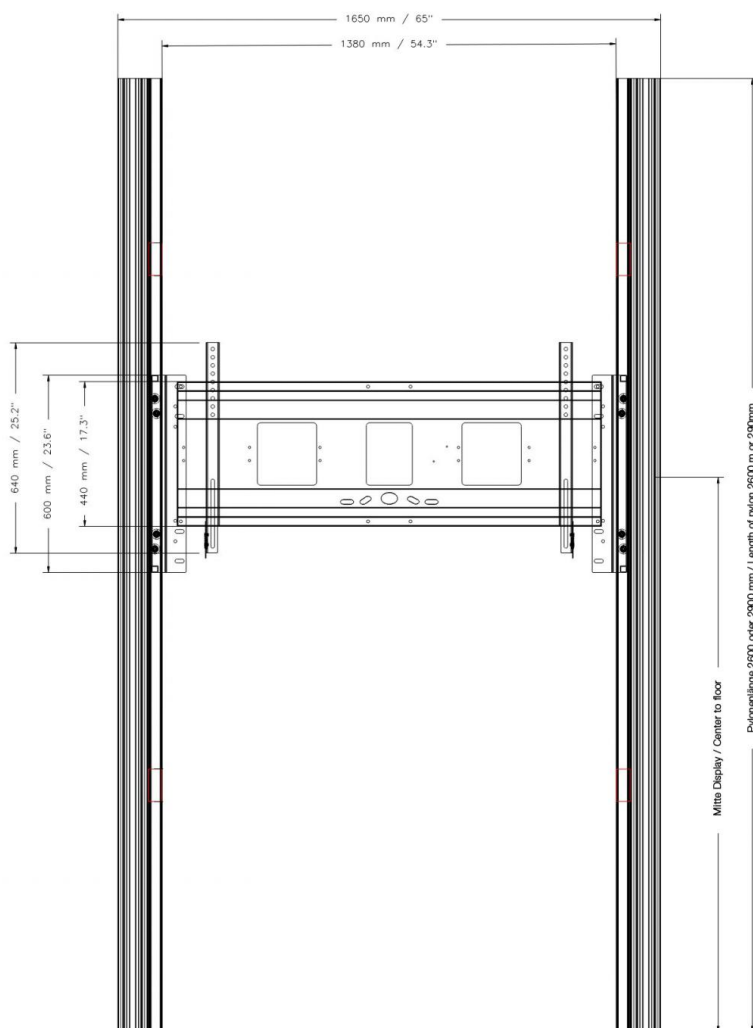

MANUFACTURER:

CONEN Produkte GmbH
Conenstr. 4
54497 Morbach-Gonzerath

Phone: +49 (0) 6533 75-100
Fax: +49 (0) 6533 75-600
E-Mail: info@conenmounts.com

Germany

www.conenmounts.com

08/06/2025
Page 2/2

CONEN

CONEN is not responsible for printing errors. CONEN reserves the right to change or modify pricing and product specifications with or without prior notification. Illustrations may not be exactly as shown. No parts may be reproduced by any means without prior authorization of CONEN. All rights reserved 2025.