

WALL MOUNTED 2 PYLON SLIDING SYSTEM FOR DISPLAYS FROM 65-86"

MANUALLY HEIGHT-ADJUSTABLE WITH PULLEY AND COUNTER WEIGHT

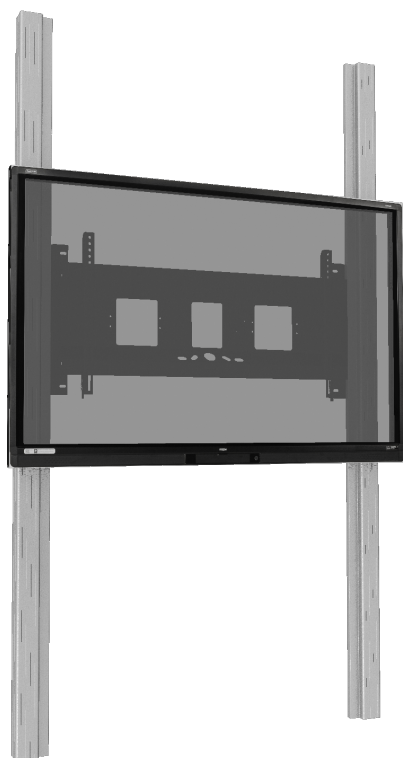

PRODUCT

This manually height-adjustable pylonsystem with pulley is compatible with all touch screen displays available on the market from 65" to 86" screen diagonal.

The two aluminum pylons are mounted on the wall and floor, the display brackets slides between these pylons by pulley and counter weight. This ensures that every user can work and present at the ergonomically best height.

Accessories



Swivel arm for notebooks



2 galvanized adjustable wall mounting brackets



2 galvanized wall mounting brackets

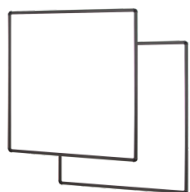

Whiteboard wings for AFSCETAN12

FEATURES

- Please indicate the model of the monitor when placing your order
- Manually height-adjustable system with 2 pylons for floor and wall mounting
- different pylon length available: 2600 mm or 2900 mm
- center to floor distance at 2900 mm length of pylon = approx. 1500 mm - 2100 mm
- center to floor distance at 2600 mm length of pylon = approx. 1150 mm - 1750 mm
- Height adjustment with counterweights and pulley
- All connections on the display are freely accessible
- at least 600 mm stroke



Display mount



Wall mounted



Manual height adjustable



Single display



Max. load
100 kg / 220.5 lbs



Max. Vesa
1200 x 600

Item number	PYF1-IFPD-W - 2600 mm lenght of pylon	
Vesa horizontal / Vesa vertical	300-800 / 200-600 mm or 300 - 1200 mm / 200 - 600 mm*	
Frame for all	65" - 86"	
Center to floor distance	1150 mm - 1750 mm	45.3" 68.9"
Load capacity	100 kg	220.5 lbs
Width / Height / Depth	1250 mm or 1650 mm* / 2600 mm / 136 mm	49.2 or 65"* / 102.4" / 5.4"
Frame color	RAL 9005 deep black	
Column color	Silver anodized	

Item number	PYF1-IFPD-W - 2900 mm lenght of pylon	
Vesa horizontal / Vesa vertical	300-800 / 200-600 mm or 300 - 1200 mm / 200 - 600 mm*	
Frame for all	65" - 86"	
Center to floor distance	1500 mm - 2100 mm	59.1" - 82.7"
Load capacity	100 kg	220.5 lbs
Width / Height / Depth	1250 mm or 1650 mm* / 2900 mm / 136 mm	49.2" or 65"* / 114.2" / 5.4"
Frame color	RAL 9005 deep black	
Column color	Silver anodized	

* depending on size of display

DIMENSIONS

in mm / inch

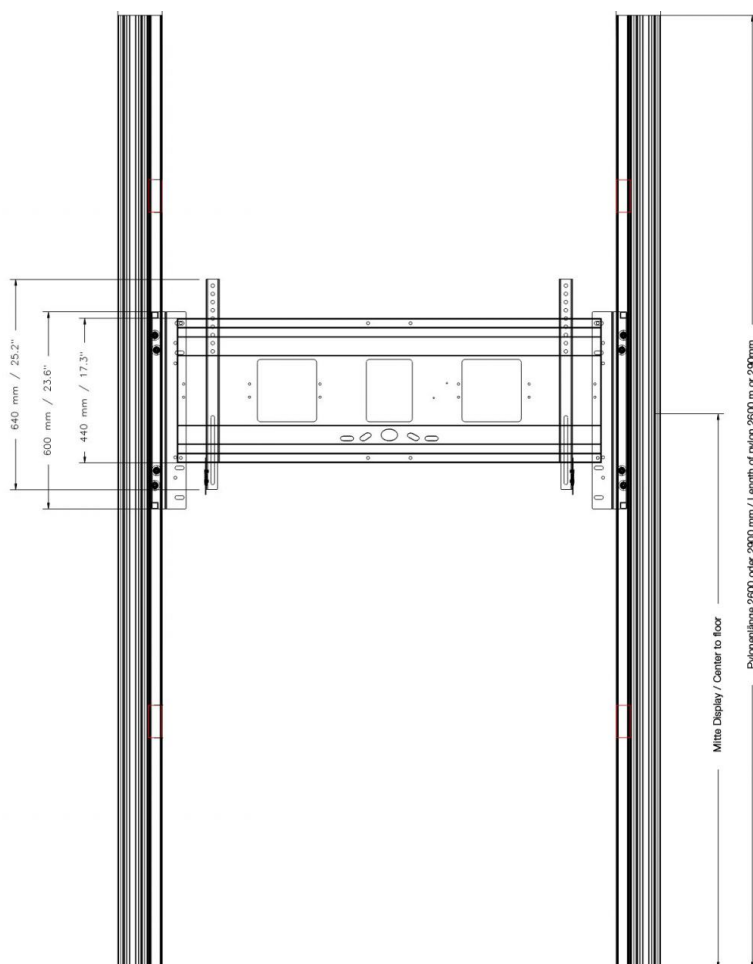

MANUFACTURER:

CONEN Produkte GmbH
Conenstr. 4
54497 Morbach-Gonzerath

Phone: +49 (0) 6533 75-100
Fax: +49 (0) 6533 75-600
E-Mail: info@conenmounts.com

Germany

www.conenmounts.com

09/09/2020
Page 2/2

CONEN

CONEN is not responsible for printing errors. CONEN reserves the right to change or modify pricing and product specifications with or without prior notification. Illustrations may not be exactly as shown. No parts may be reproduced by any means without prior authorization of CONEN. All rights reserved 2020.